

SEZIONE TIPO SCAVO PER  
POSA TUBAZIONI ACQUEDOTTO

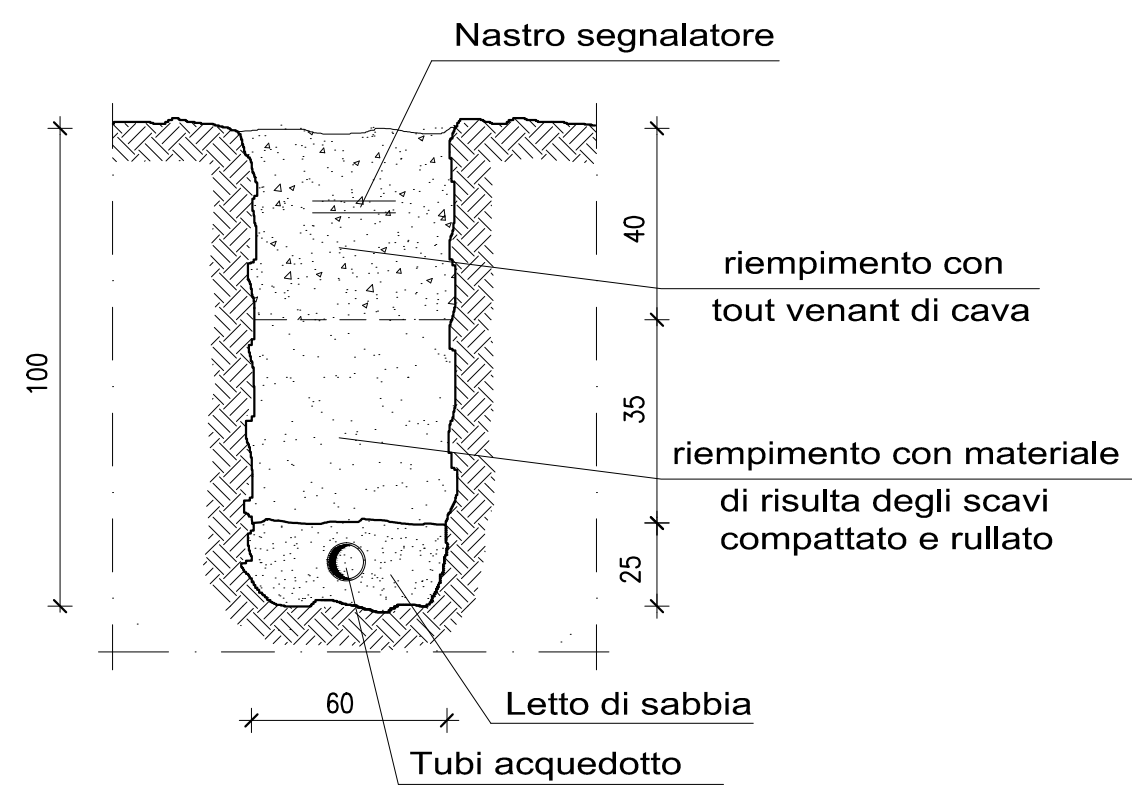

PARTICOLARI ACQUEDOTTO

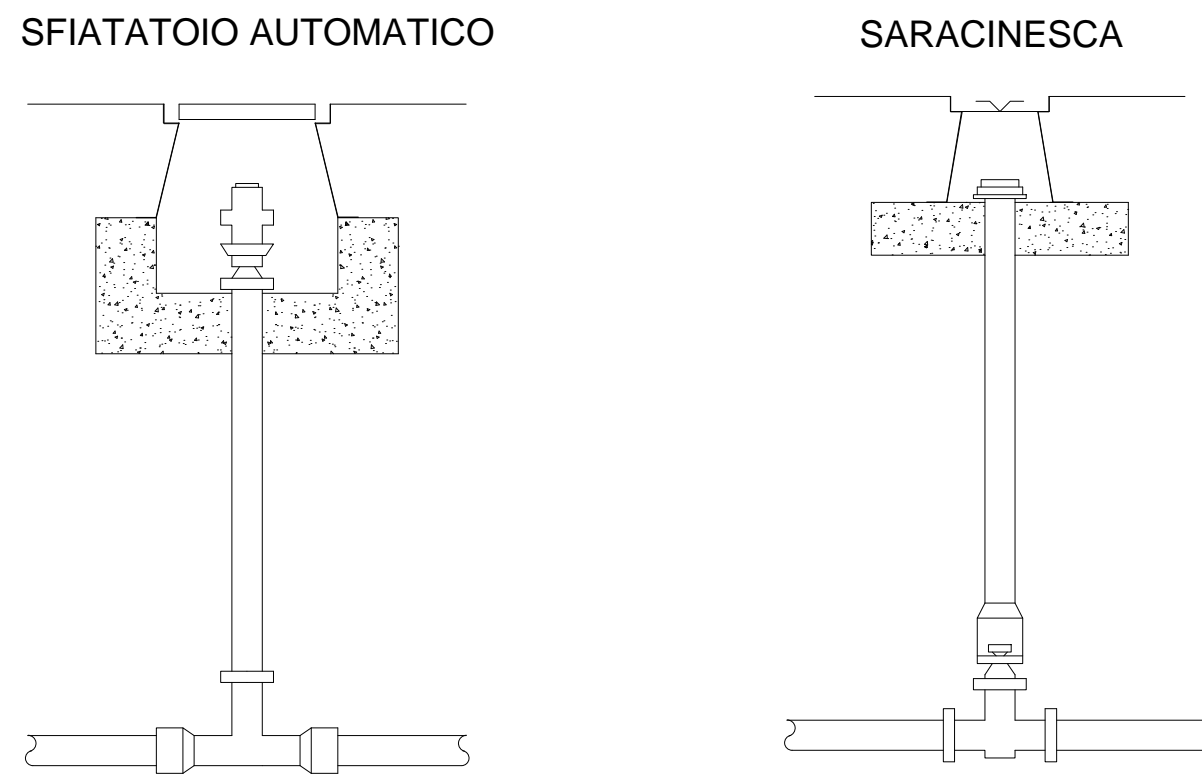

PARTICOLARE ALLACCIAMENTO

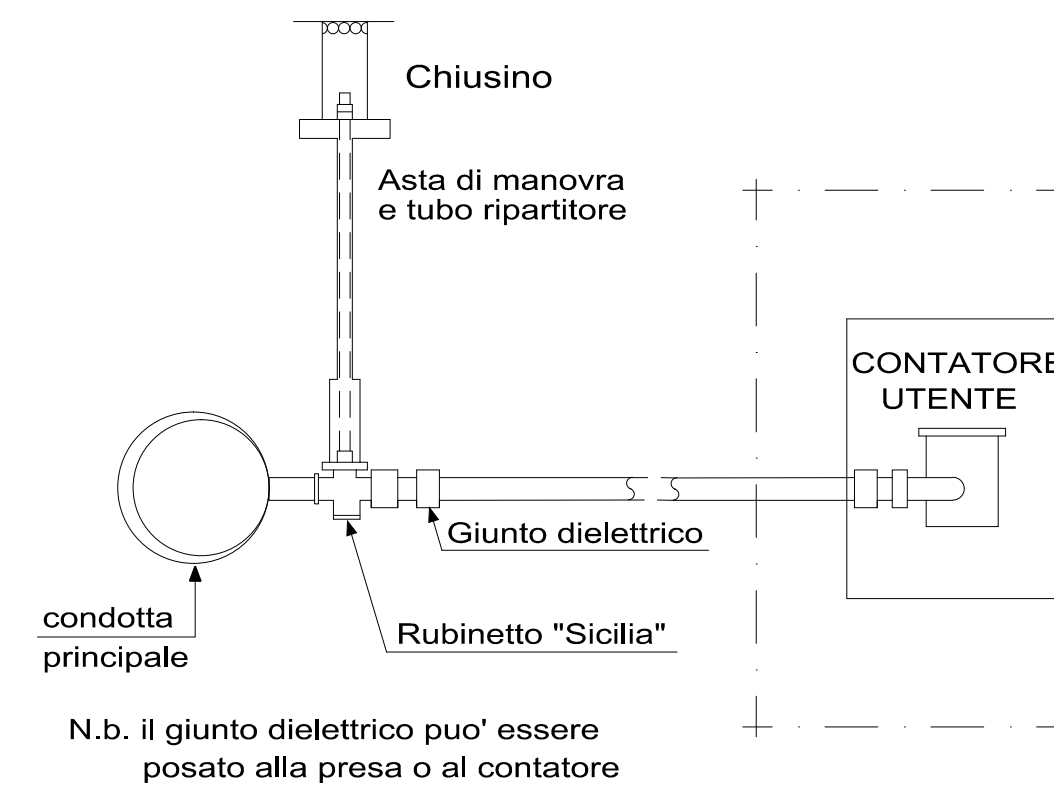

PARTICOLARI METANODOTTO

SEZIONE TIPO SCAVO PER  
POSA TUBAZIONI METANODOTTO

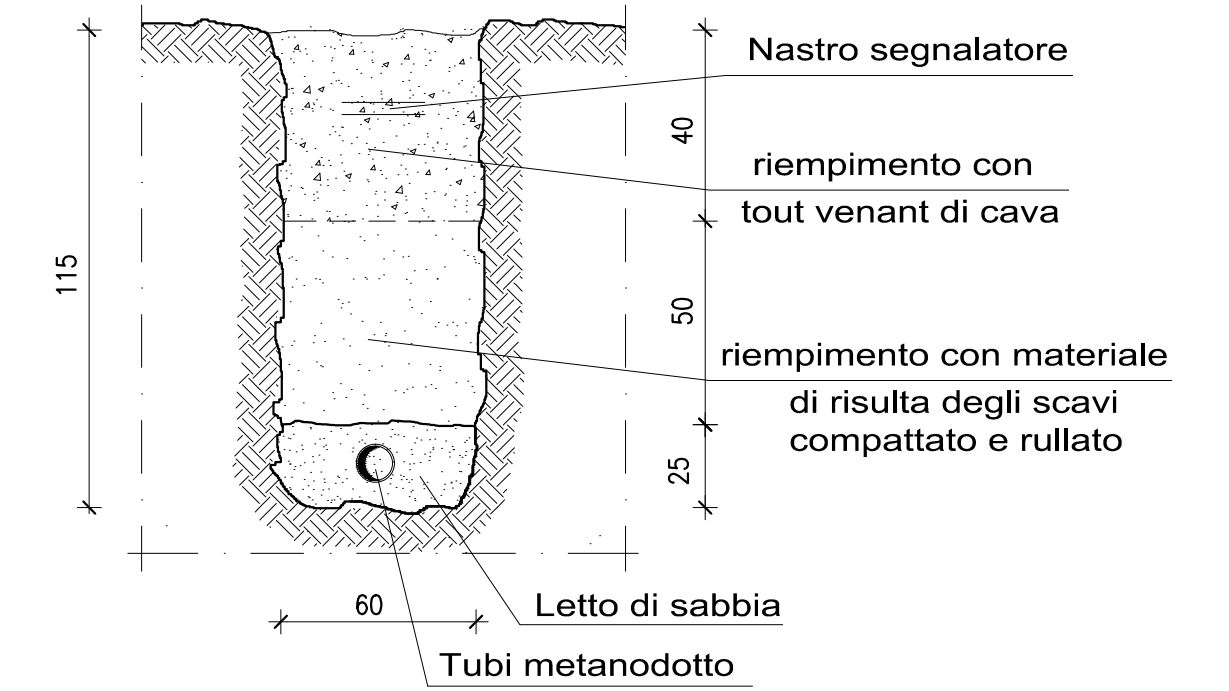

SEZIONE TIPO SCAVO PER  
POSA TUBAZIONI ENEL

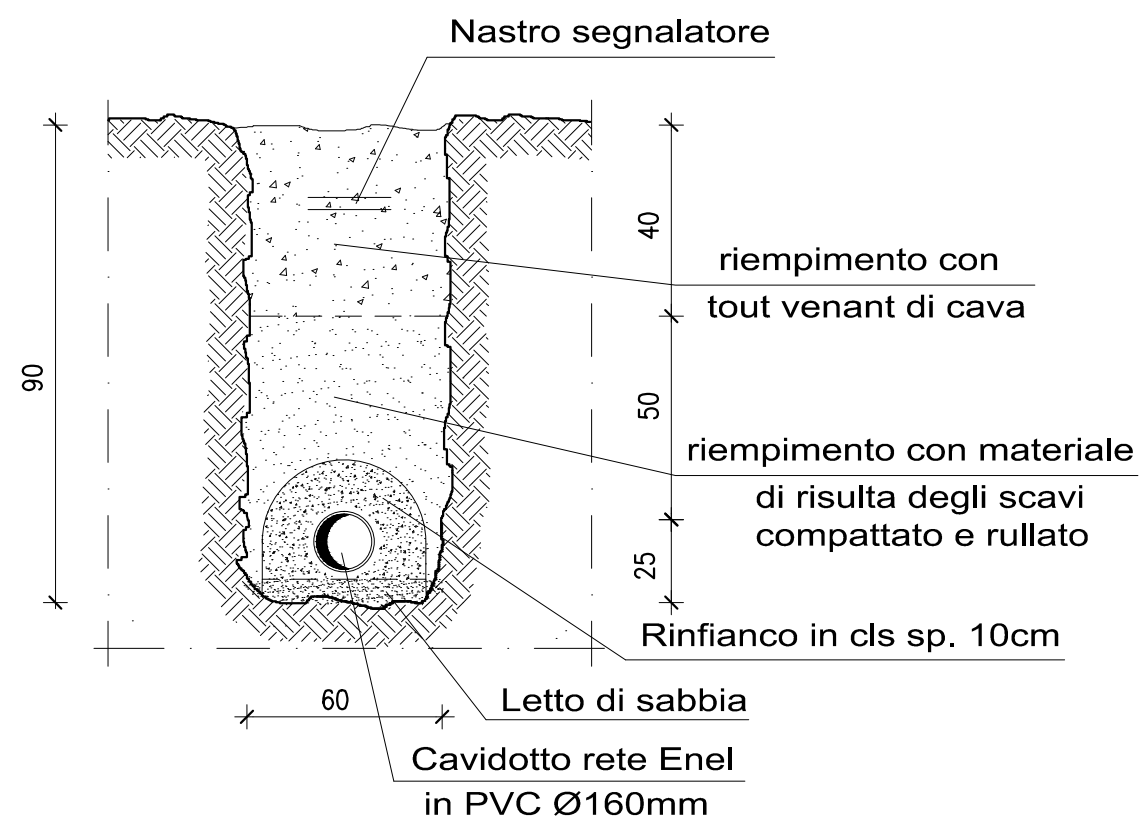

PARTICOLARI ENEL

POZZETTO CON CHIUSINO DI TIPO  
STRADALE IN GHISA SFEROIDALE

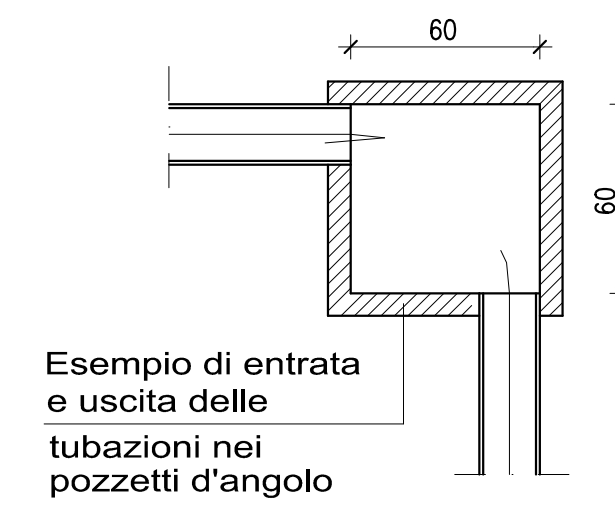
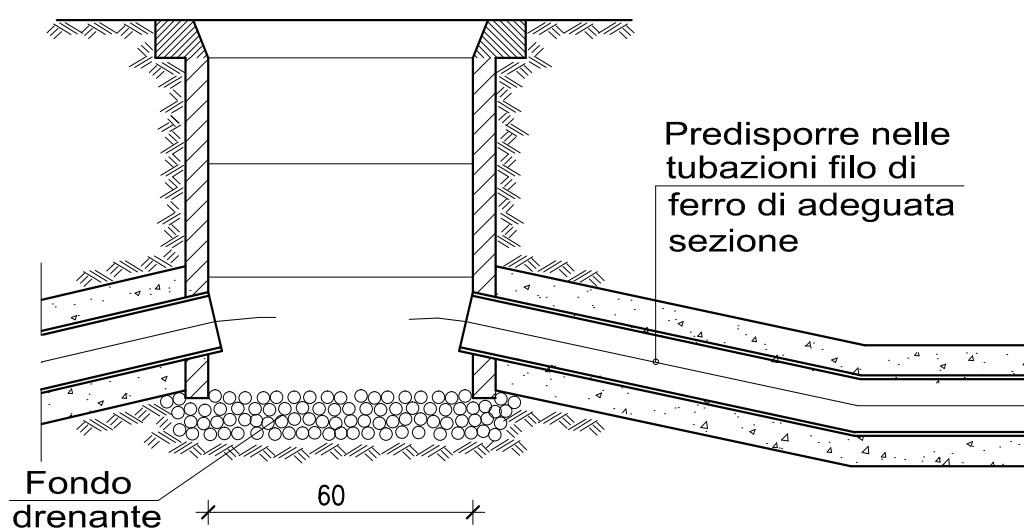

PARTICOLARI PUBBLICA ILLUMINAZIONE

SEZIONE TIPO SCAVO PER POSA  
TUBAZIONI PUBBLICA ILLUMINAZIONE

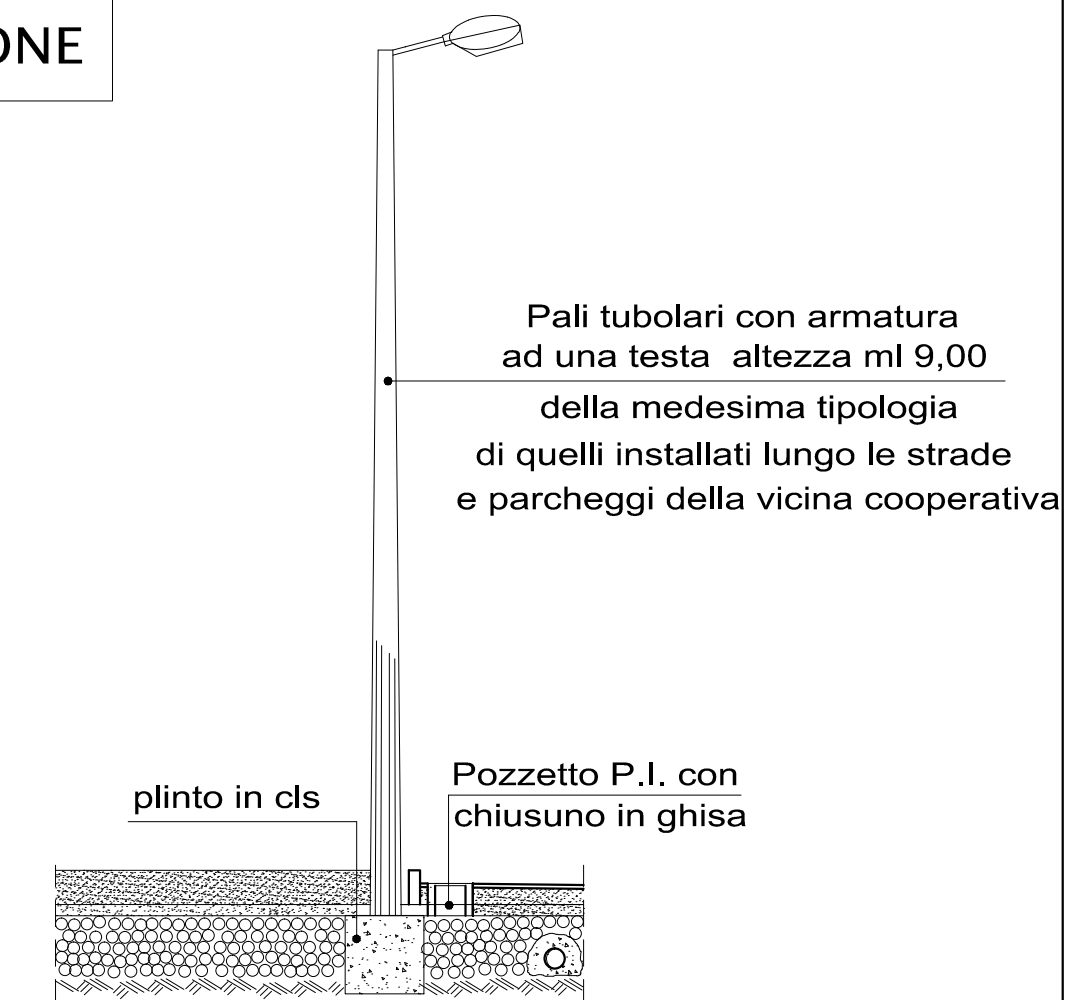
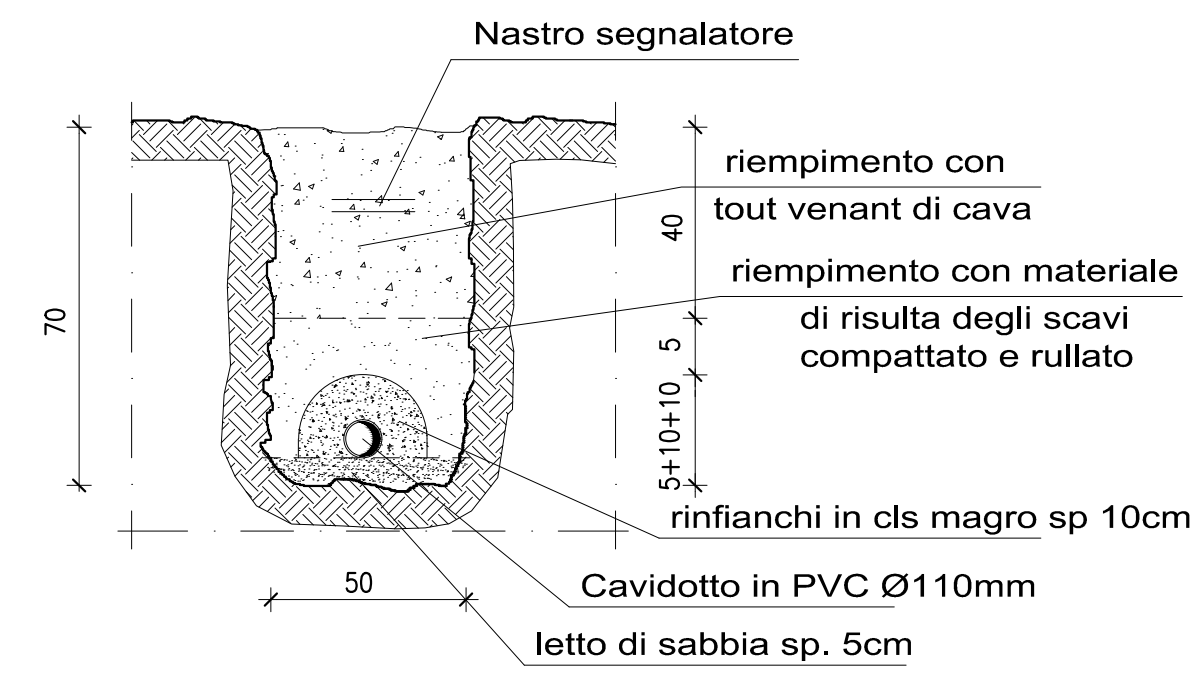

SEZIONE TIPO SCAVO PER  
POSA TUBAZIONI TELECOM

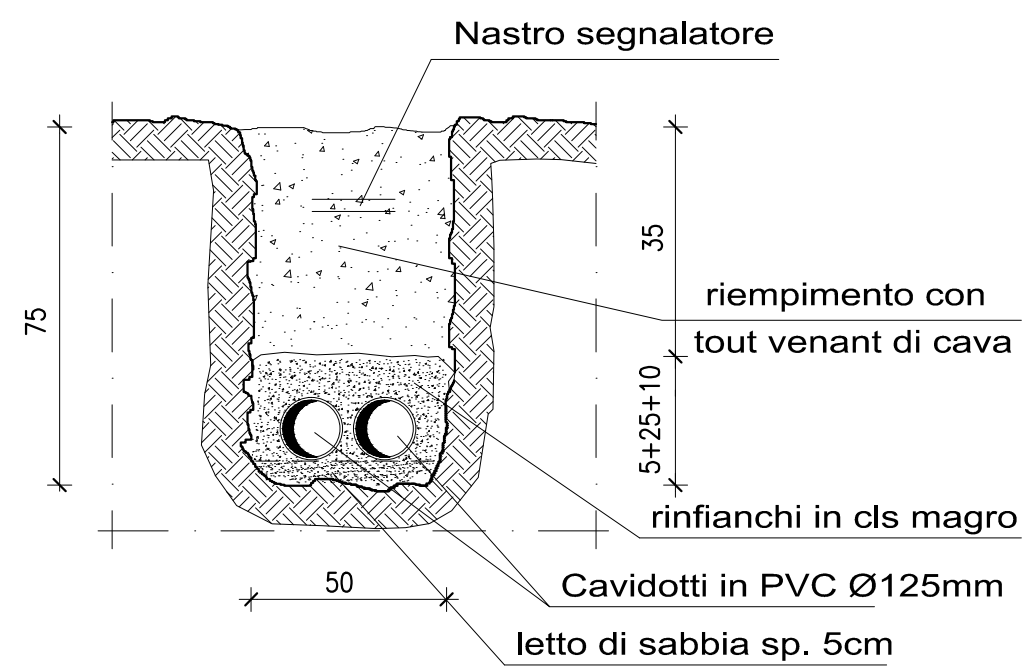

POZZETTO m0.60x0.60x1.00

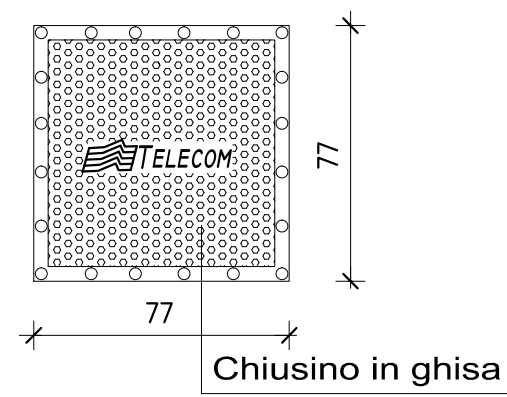
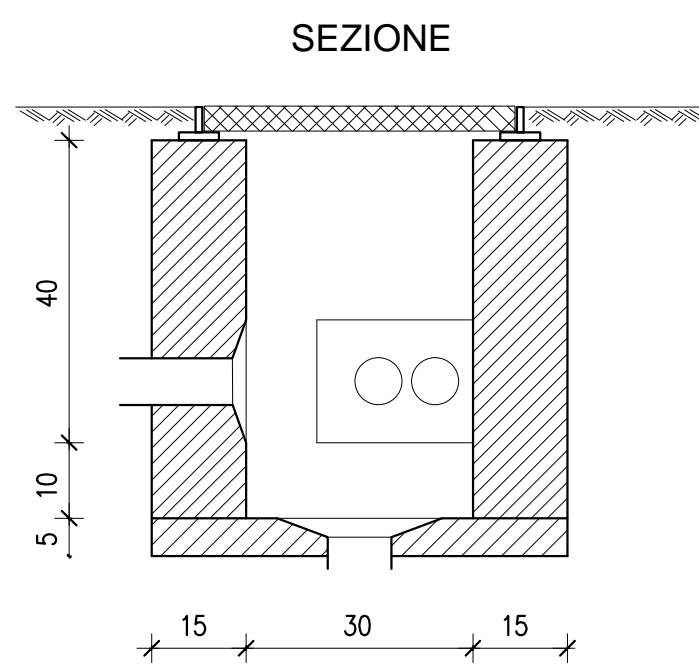

PARTICOLARI TELECOM

POZZETTO m0.60x1.20x1.00

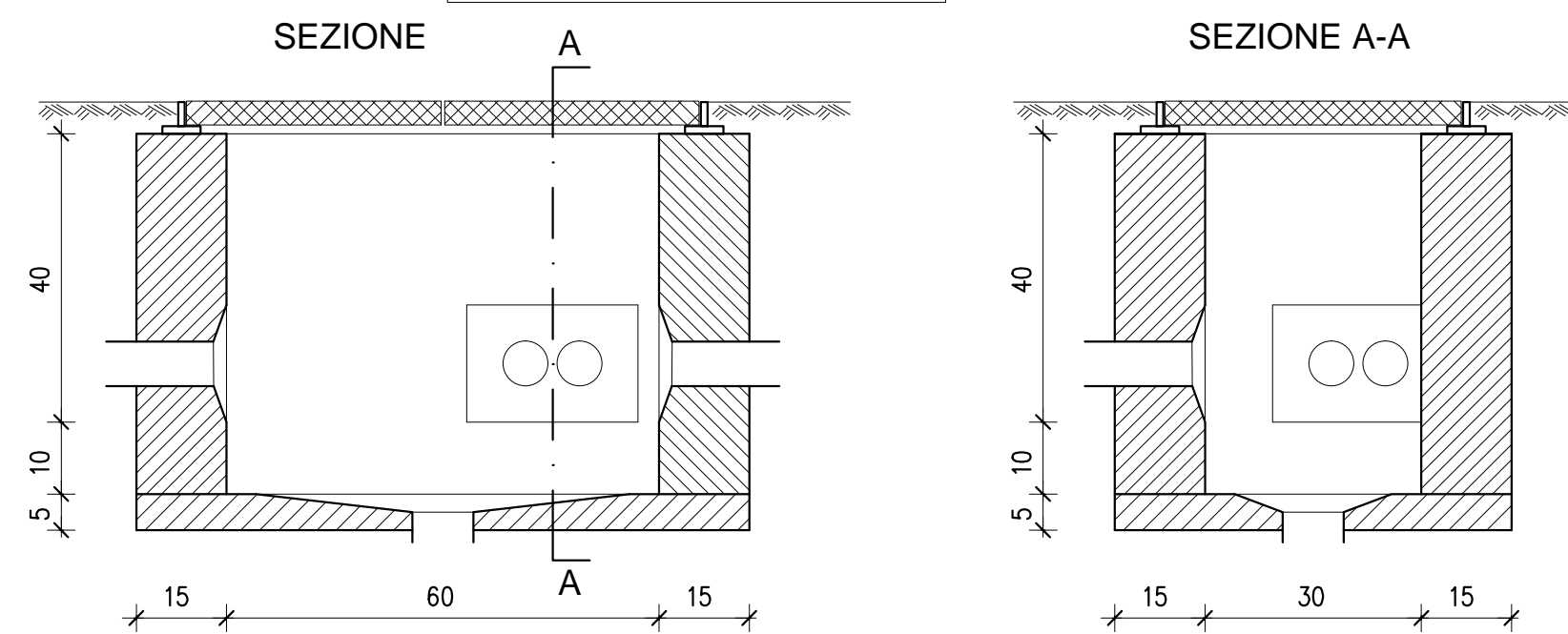

INTERFERENZA TUBAZIONI

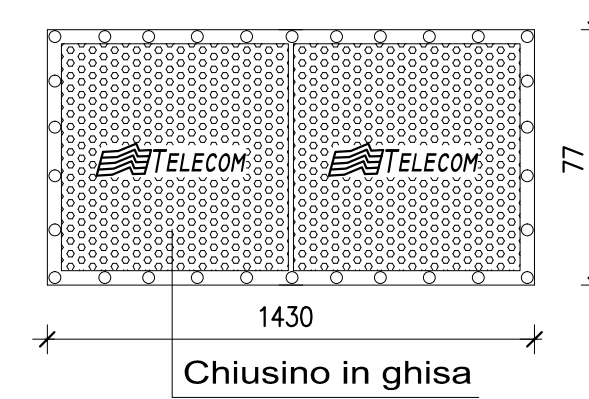
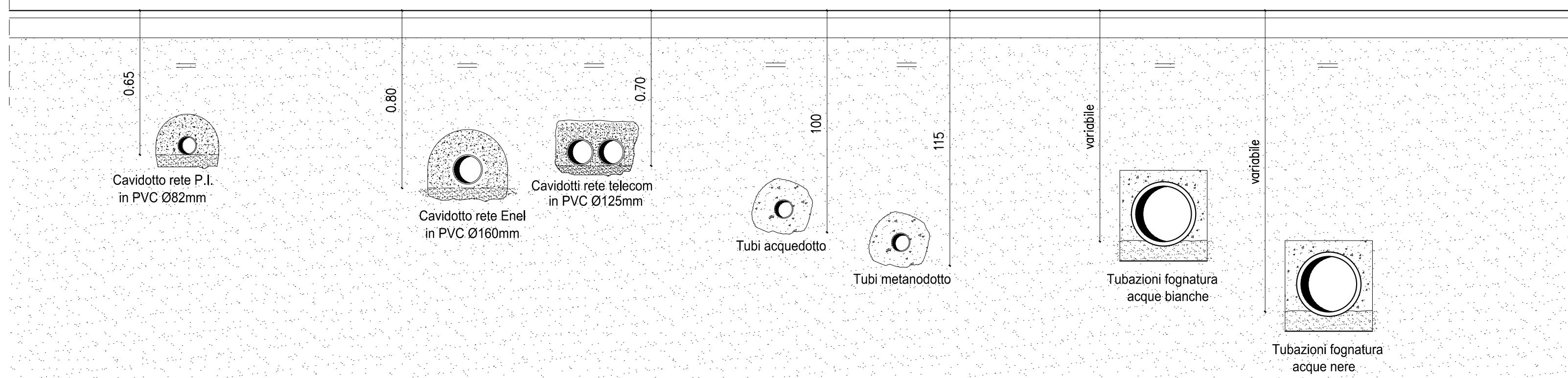

Comune di Treviolo Provincia di Bergamo  
committenti: Attuatori di P.L.

Piano Attuativo in viale Europa denominato "EP5"

Particolari reti sottoservizi			10
data:	agg:	scala:	

Progettisti:  
 Guido Rubini ingegnere  
 Roberto Rocchi architetto  
 Matteo Rubini architetto  
 Marco Papa geometra  
 via G. Garibaldi 7  
 24122 Bergamo  
 tel. 035/221056  
 ing.rubini@virgilio.it